

Rev.	Description	Date	Drawn	Checked	Approved

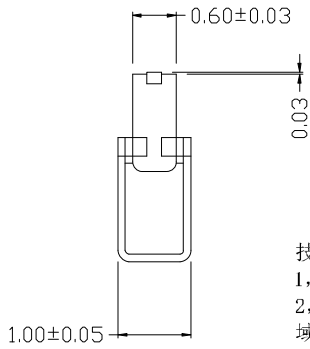
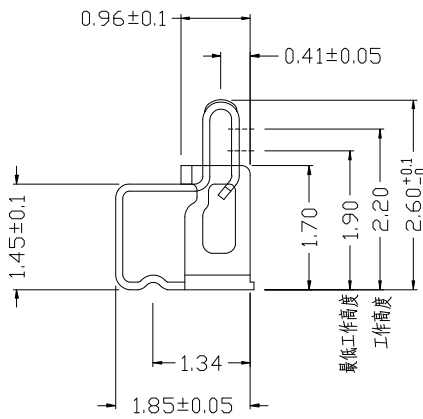
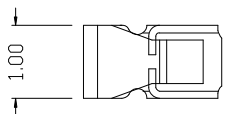

技术要求：
 1, 材质: SUS301, 0.1厚
 2, 电镀: 所有表面镀镍50唛, 接触点及焊盘区域镀金1唛
 3, 工作高度弹力 >0.5 N
 4, 卷盘包装

朗顿电子

GENERAL TOLERANCE	
XX. ±0.50	
X. ±0.35	X.* ±2.0°
.X ±0.15	.X.* ±1.0°
.XX ±0.1	.XX.* ±0.5°

SCALE: 12:1
UNIT: mm
SIZE: A4

DRAWN: ZHENG	DATE
CHECK	DATE
APPROVE	DATE

DWG. NO.	PARTS NO.(INTENDED USE)
AS-055	

TITLE
2.6011 五金弹片
1.9X1.0X2.60

REV. A
SHEET 1/1