

RoHS
Compliant

SYMBOL	REVISION	APPROVAL	DATE

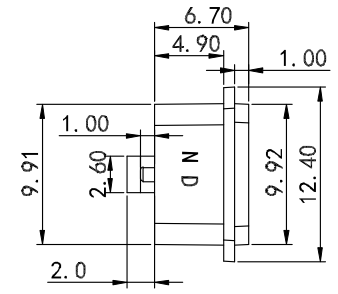

NOTE:
Material
 Insulator: LCP
 Contact: C7521
 Contact Plated: Gold over Nickel or Tin
Specification
 Current Rating: 12A
 Instant Current: 15A
 Rated Voltage: 12V
 Contact Resistance: 30mΩ
 Insulation Resistance: 100MΩ
 Dielectric Voltage: 500V
 Operating Temperature: -40° ~105°

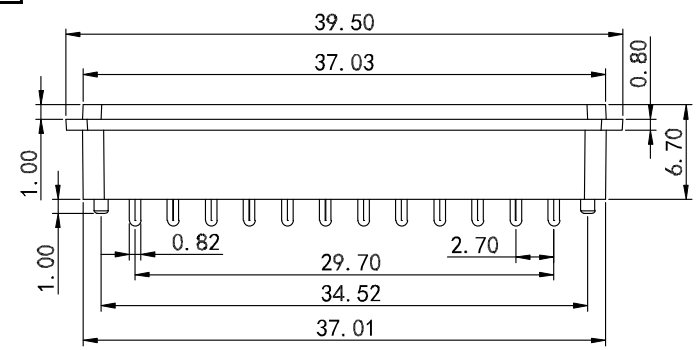
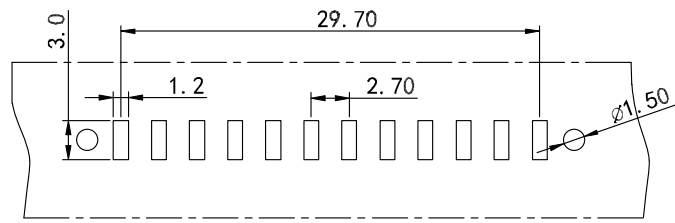
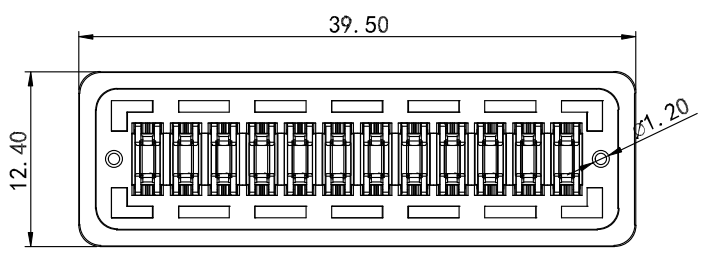

RECOMMENDED PCB LAYOUT
 T=0.65MM, TOLERANCES ±0.05MM

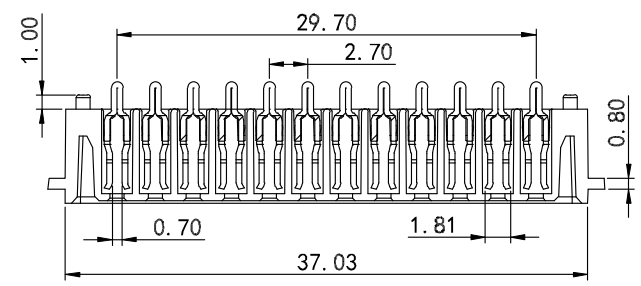

2	HOUSING	LCP	1	GRAY
1	CONTACT TERMINAL	C7521	12	Au PLATED
NO.	PARTS	MATERIAL	QTY.	FINISHING

东莞市朗顿电子科技有限公司

COPYRIGHT RESERVED, PLEASE DO NOT COPY.

PART NAME		CONNECTOR		DRAWING	Y. C. Zhang	DWG. No.	
PART NO.		LD-B31F-12P-S1		CHECK	G. C. Chen	REV.	A1
UNIT	TOLERANCE	UP TO 5	±0.2	ANGLE	APPROVAL	DATE	24-11-2020
mm	OTHERWISE	ABOVE 5 ~30	±0.3	0° ±3°	SCALE	2:1	PAGE
		ABOVE 30	±0.5				1 OF 1
		ANGLE	±3°				