

REV.	DESCRIPTION	DRAW.	DATE.

No:of pins	Dimension			
	DIM.A	DIM.B	DIM.C	DIM.E
02	2.50	6.50	9.45	2.1/3.0
03	5.00	9.00	11.95	2.1/3.0
04	7.50	11.50	14.45	2.1/3.0
05	10.00	14.00	16.95	2.1/3.0
06	12.50	16.50	19.45	2.1/3.0
07	15.00	19.00	21.96	2.1/3.0
08	17.50	21.50	24.45	2.1/3.0
09	20.00	24.00	26.95	2.1/3.0
10	22.50	26.50	29.45	2.1/3.0
11	25.00	29.00	31.95	2.1/3.0
12	27.50	31.50	34.45	2.1/3.0
13	30.00	34.00	36.95	2.1/3.0
14	32.50	36.50	39.45	2.1/3.0
15	35.00	39.00	41.95	2.1/3.0
16	37.50	41.50	44.45	2.1/3.0

Material
 Insulator:Nylon 9T(UL94V-0)
 Contact:phosphor Bronze
 Contact Plated:Gold over Nickel or Tin
 Specification
 Current rating:7A
 instant CURRENT:10A
 Contact Resistance:30MΩ
 Insulation Resistance:100MΩ
 Dielectric Voltage:500V
 Operdting Temperature:-40~105°

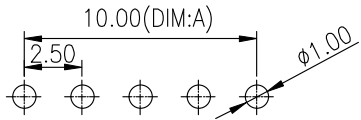

Recommended P.C.B Layout
 Layout Tolerance= +/-0.05mm

东莞市朗顿电子科技有限公司

UNLESS OTHERWISE SPECIFIED,TOLERANCE: X. ±0.20 X.x ±0.15 X.xx ±0.10 ANGULAR ±2'	DESIGN	Elih	DATE	2014.08.26	TITLE: Battery 180° 2.5mm Pitches Female Connector	
	APPROVED		DATE		SCALE: 1:1	UNIT: mm
	PART NO	LD-B01F-A-S1-S2	REV: 01		SHEET: 1/1	
	DRAWING NO	LD-B01F-A-S1-S2	SIZE: A4			