

RoHS
Compliant

| SYMBOL | REVISION | APPROVAL | DATE |
|--------|----------|----------|------|
| | | | |
| | | | |

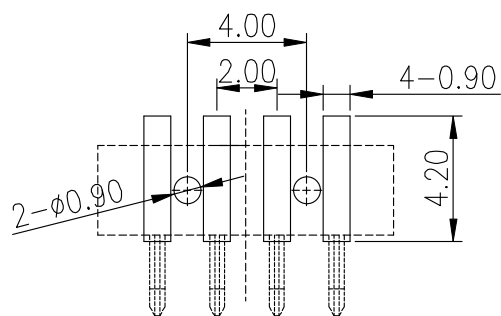

NOTE:
 Material
 Insulator: LCP
 Contact: C2680
 Contact Plated: Gold over Nickel or Tin
 Specification
 Current rating: 3A
 instant CURRENT: 5A
 Contact Resistance: 30mΩ
 Insulation Resistance: 100MΩ
 Dielectric Voltage: 500V
 Operdting Temperature: -40°~105°

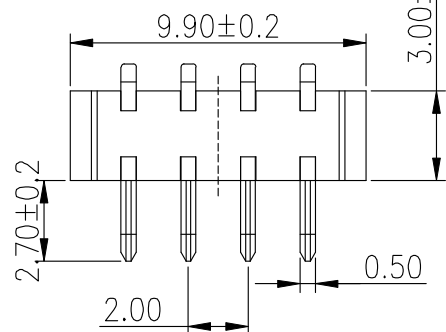
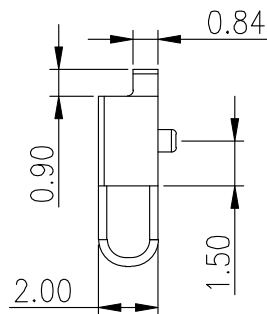
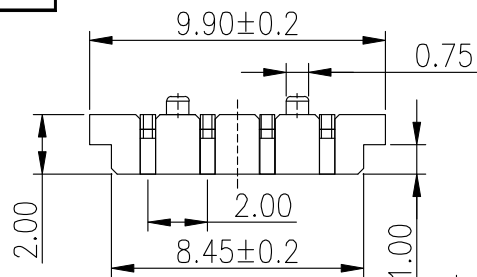
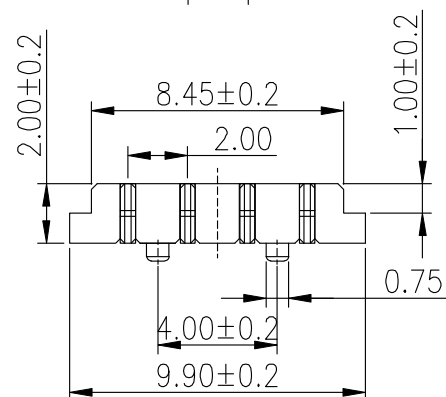

RECOMMENDED P.C.B LAYOUT
TOP VIEW (.XX±0.05)

| | | | | |
|-----|------------------|----------|------|-----------|
| 2 | HOUSING | LCP | 1 | GRAY |
| 1 | CONTACT TERMINAL | C2680 | 4 | Au PLATED |
| NO. | PARTS | MATERIAL | QTY. | FINISHING |

东莞市朗顿电子科技有限公司

| | | | | | | |
|-------------|------------|-----------------------------|----------|-----------|---------|------------|
| PART NAME | CONNECTOR | | DRAWING | Y.C.Zhang | DWG.No. | |
| PART NO. | A00M-4P-R5 | | CHECK | G.C.Chen | REV. | A1 |
| UNIT: mm | TOLERANCE | UP TO 5 ABOVE 5 30 | APPROVAL | | DATE | 01-05-2020 |
| | OTHERWISE | ±0.2 ±0.3 ±0.5 ±3° | SCALE | 2:1 | PAGE | 1 OF 1 |

COPYRIGHT RESERVED, PLEASE DO NOT COPY.