

F

E

D

C

B

A

1

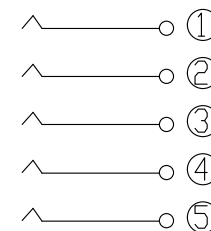
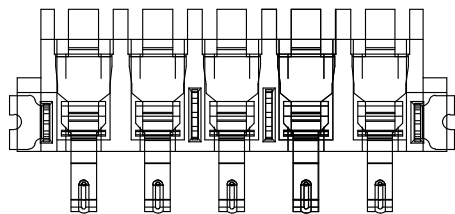

性能 :

额定电流 : 2.0A

额定电压 : 12V

CIRCUIT

耐压 : 500V

接触电阻 : 30mΩ

绝缘电阻 : 500MΩ

工作温度 : -40℃~+85℃

塑件(材质) : LCP

接触点(材质) : 磷铜, 镀金

2

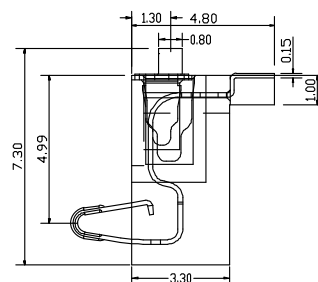
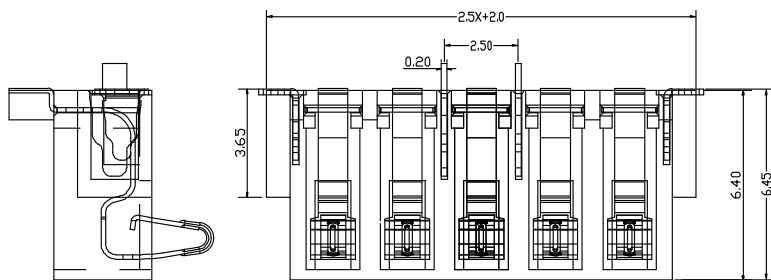

3

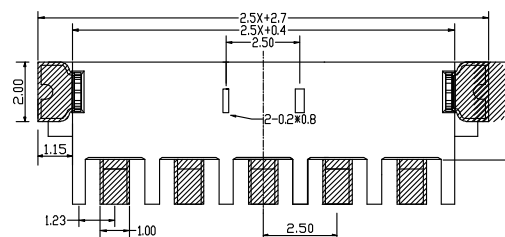
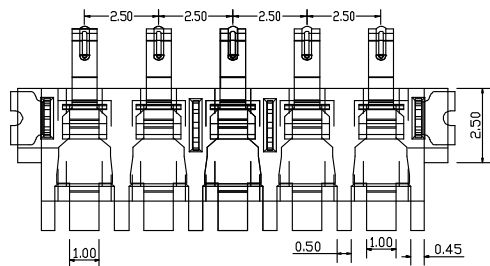

PCB LAYOUT (5pin)

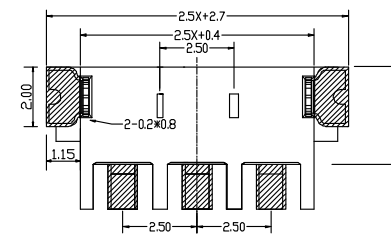

PCB LAYOUT (3pin)

4

2	HOUSING	LCP	1	BLACK
1	CONTACT TERMINAL	BeCu	3	Au PLATED
NO.	PARTS	MATERIAL	QTY.	FINISHING

东莞市朗顿电子科技有限公司

COPYRIGHT RESERVED, PLEASE DO NOT COPY.

PART NAME		CONNECTOR		DRAWING	G.B.Wu	DWG.No.	DS-BC-169
PART NO.		BC-2-308/501		CHECK	Q.L.Dai	REV.	A0
UNIT :	TOLERANCE OTHERWISE	UP TO 5	±0.2	ANGLE	APPROVAL	DATE	25-04-2017
		ABOVE 5 30	±0.3			SCALE	2:1
mm		ABOVE 30	±0.5	0'±3'			

F

E

D

C

B

A