

性能:

- 额定电流: 2.0A
- 额定电压: 12V
- 耐电压: 500V
- 接触电阻: 30mΩ
- 绝缘电阻: 500MΩ
- 工作温度: -40°C ~ +85°C
- 塑件(材质): LCP
- 接触点(材质): 磷铜, 触点镀金3U"
- 使用寿命: 3000次以上

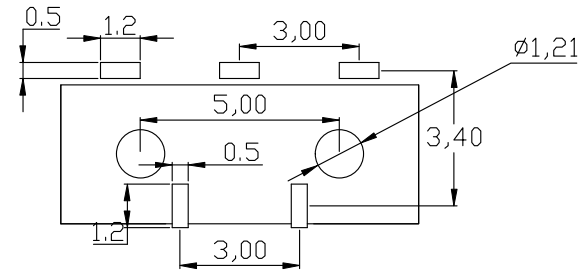

RECOMMENDED PCB LAYOUT  
TOL:(±0.05)

2	HOUSING	LCP	1	BLACK
1	CONTACT TERMINAL	Phosphor bronze	3	Au PLATED
NO.	PARTS	MATERIAL	QTY.	FINISHING

东莞市朗顿电子科技有限公司

COPYRIGHT RESERVED, PLEASE DO NOT COPY.

PART NAME		CONNECTOR		DRAWING		G.B.Wu		DWG.No.		DS-BC-157	
PART NO.		BC-2-371		CHECK		Q.L.Dai		REV.		A0	
UNIT	:	TOLERANCE	UP TO 5	±0.2	ANGLE	APPROVAL	DATE	12-10-2019		PAGE	1 OF 1
			ABOVE 5 30 ~	±0.3							
mm		OTHERWISE	ABOVE 30	±0.5	0°±3'	SCALE	2:1				