

RoHS
Compliant

SYMBOL	REVISION	APPROVAL	DATE

SPECIFICATIONS

- ELECTRICAL CHARACTERISTICS:
 - 1-1.RATING: DC 12V 2A
 - 1-2.CONTACT RESISTANCE: 20mΩ MAX(INITAL)
 - 1-3.DIELECTRIC WITHSTANDING VOLTAGE: 500V AC FOR ONE MINUTE
 - 1-4.INSULATION RESISTANCE: 100MΩ MIN, MEASURED BY 500V DC
- LIFE TEST:MECHANICAL LIFE TEST 10,000 CYCLES.

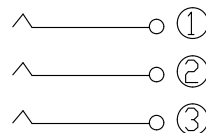
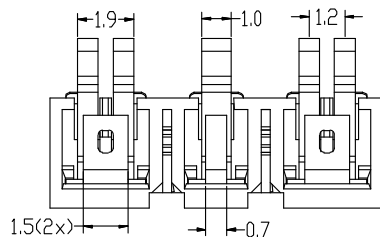
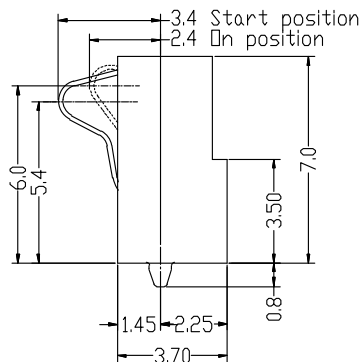
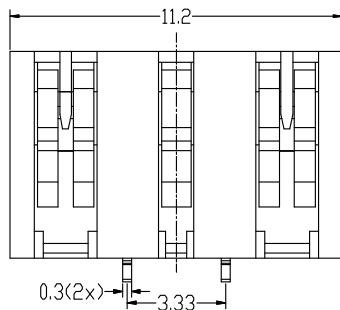
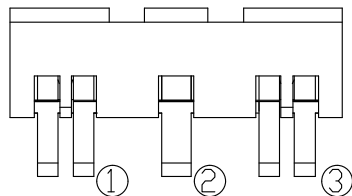

CIRCUIT

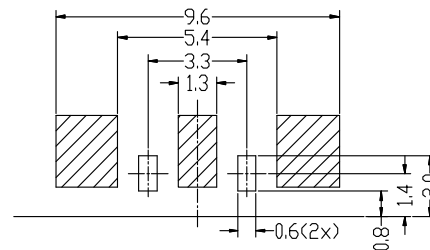

P.C.B LAYOUT

3	HOUSING	LCP	1	BLACK
2	EARTH TERMINAL	C2680	1	Sn PLATED
1	CONTACT TERMINAL	BeCu	3	Au PLATED
NO.	PARTS	MATERIAL	QTY.	FINISHING

东莞市朗顿电子科技有限公司

PART NAME		CONNECTOR		DRAWING	Y,C,ZHANG	DWG.No.	DS-BC-175	
PART NO.		BC-2-368		CHECK	G.C.Chen	REV.	A1	
UNIT :	TOLERANCE OTHERWISE	UP TO 5	±0.2	ANGLE	APPROVAL	DATE	22-05-2017	
		ABOVE 5~30	±0.3			SCALE	PAGE	1 OF 1
		ABOVE 30	±0.5					
mm		ANGLE	±3'					

COPYRIGHT RESERVED,PLEASE DO NOT COPY.

F

E

D

C

B

A