

性能:
 额定电流: 2.0A
 额定电压: 12V
 耐电压: 500V
 接触电阻: 30mΩ
 绝缘电阻: 500MΩ
 工作温度: -40℃~+85℃
 塑件(材质): LCP
 接触点(材质): 磷铜, 触点镀金3U"

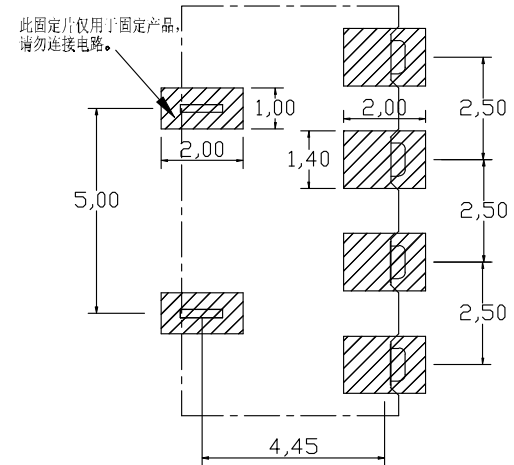

RECOMMENDED PCB LAYOUT
 TOP VIEW (. XX ± 0.05)

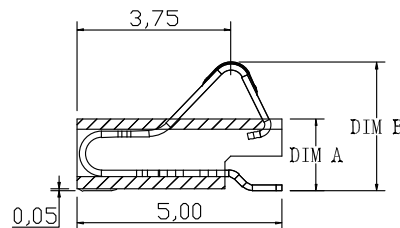
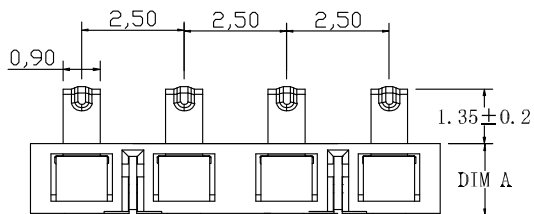
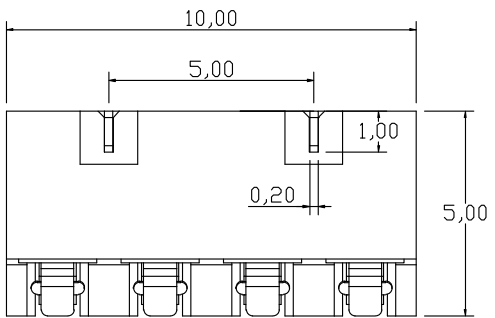

PART NO.	DIM A	DIM B	2	HOUSING	LCP	1	BLACK
BC-1-415	1.7	3.00±0.2	1	CONTACT TERMINAL	PHOSPHOR BRONZE	3	Au PLATED
BC-1-415A	2.0	3.30±0.2	NO.	PARTS	MATERIAL	QTY.	FINISHING

东莞市朗顿电子科技有限公司

PART NAME		CONNECTOR		DRAWING	G.B.Wu	DWG.No.	DS-BC-112
PART NO.		BC-1-415/415A		CHECK	Q.L.Dai	REV.	A0
UNIT : mm	TOLERANCE	UP TO 5	±0.2	APPROVAL	DATE	PAGE	07-09-2017
	OTHERWISE	ABOVE 5 30 ~	±0.3				
		ABOVE 30	±0.5				
		ANGLE	±3°				

COPYRIGHT RESERVED, PLEASE DO NOT COPY.