

F

E

D

C

B

A

1

1

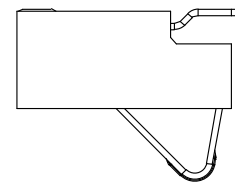
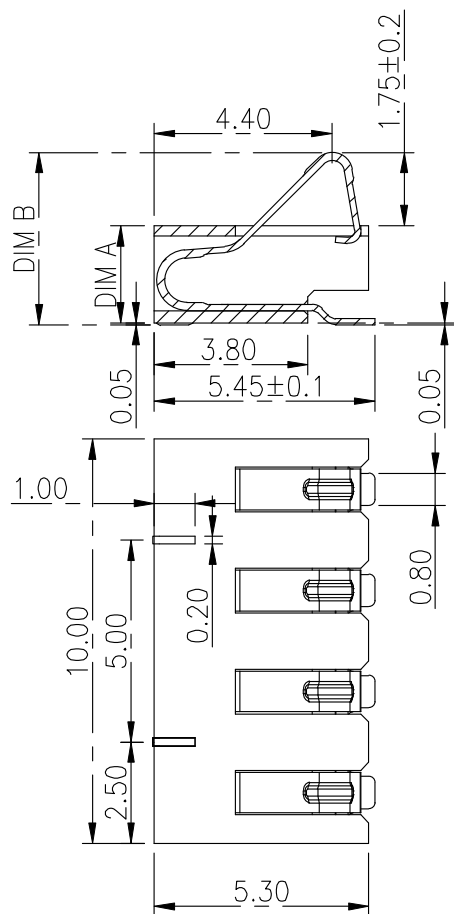

性能:

额定电流: 2.0A

额定电压: 12V

耐电压: 500V

接触电阻: 30mΩ

绝缘电阻: 500MΩ

工作温度: -40℃~+85℃

塑件(材质): LCP

接触点(材质): 磷铜, 触点镀金3U"

2

2

3

3

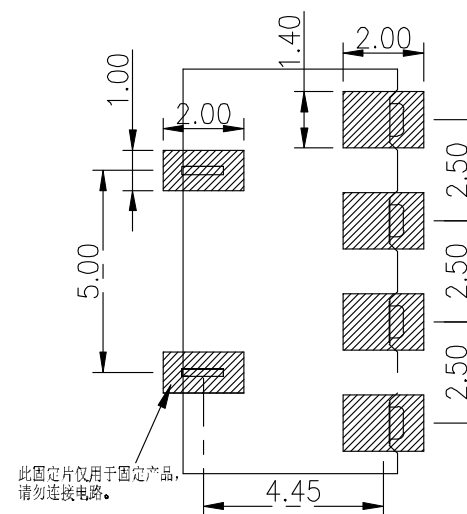

RECOMMENDED PCB LAYOUT

TOP VIEW(. XX±0.05)

PART NO.	DIM A	DIM B						
BC-1-414	2.4	4.2	2	HOUSING	LCP	1	BLACK	
BC-1-414A	3.0	4.8	1	CONTACT TERMINAL	PHOSPHOR BRONZE	3	Au PLATED	
BC-1-414B	3.5	5.3	NO.	PARTS	MATERIAL	QTY.	FINISHING	

4

4

东莞市朗顿电子科技有限公司

PART NAME		CONNECTOR		DRAWING		G.B.Wu		DWG.No.		DS-BC-109	
PART NO.		BC-1-414/414A/414B		CHECK		Q.L.Dai		REV.		A0	
UNIT : mm	TOLERANCE	UP TO 5	±0.2	ANGLE	APPROVAL	DATE	03-09-2017	PAGE	1 OF 1		
	OTHERWISE	ABOVE 5 30 ~	±0.3							SCALE	2:1

COPYRIGHT RESERVED, PLEASE DO NOT COPY.

F

E

D

C

B

A