

性能:

额定电流: 2.0A
 额定电压: 12V
 耐电压: 500V
 接触电阻: 30mΩ
 绝缘电阻: 500MΩ
 工作温度: -40℃~+85℃
 使用寿命: 5000次以上
 塑件(材质): LCP(黑色) UL94-V0
 接触点(材质): 锡磷青铜, 触点镀金3U",
 焊脚镀金1U", 镍30-80U"
 固定片(材质): 黄铜C2680,
 镀全雾锡70U"以上, 镍底30-80U"
 环保要求: 符合ROHS限值。

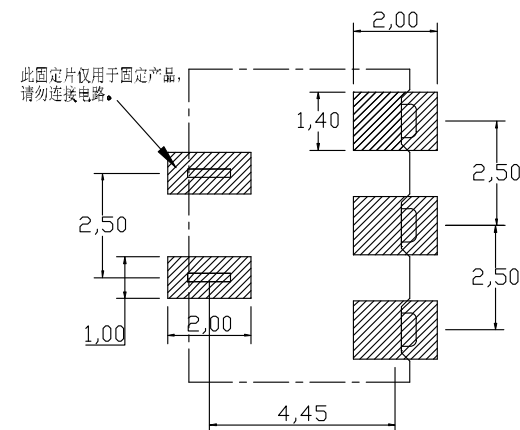

RECOMMENDED PCB LAYOUT
 TOP VIEW (.XX±0.05)

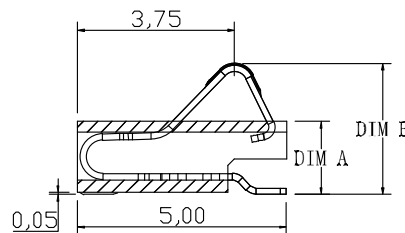
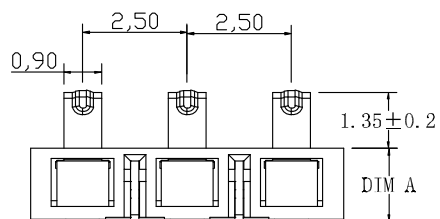
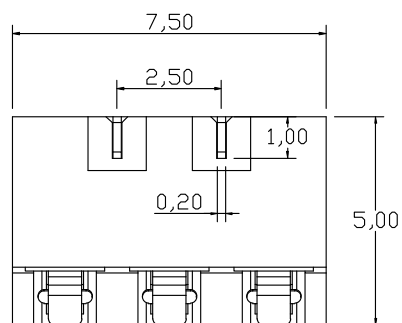

PART NO.	DIM A	DIM B	2	HOUSING	LCP	1	BLACK
BC-1-321	1.7	3.05±0.2	1	CONTACT TERMINAL	PHOSPHOR BRONZE	3	Au PLATED
BC-1-321A	2.0	3.35±0.2	NO.	PARTS	MATERIAL	QTY.	FINISHING

东莞市朗顿电子科技有限公司

PART NAME		CONNECTOR		DRAWING		G.B.Wu		DWG.No.		DS-BC-111	
PART NO.		BC-1-321/321A		CHECK		Q.L.Dai		REV.		A0	
UNIT : mm	TOLERANCE OTHERWISE	UP TO 5	±0.2	ANGLE	APPROVAL	DATE	06-09-2017	PAGE	1 OF 1		
		ABOVE 5 30 ~	±0.3							SCALE	2:1
		ABOVE 30	±0.5	0°±3'							

COPYRIGHT RESERVED, PLEASE DO NOT COPY.