

性能:

- 额定电流: 2.0A
- 额定电压: 12V
- 耐电压: 500V
- 接触电阻: 30mΩ
- 绝缘电阻: 500MΩ
- 工作温度: -40℃~+85℃
- 塑件(材质): LCP 黑色
- 接触点(材质): 铜合金, 镀金

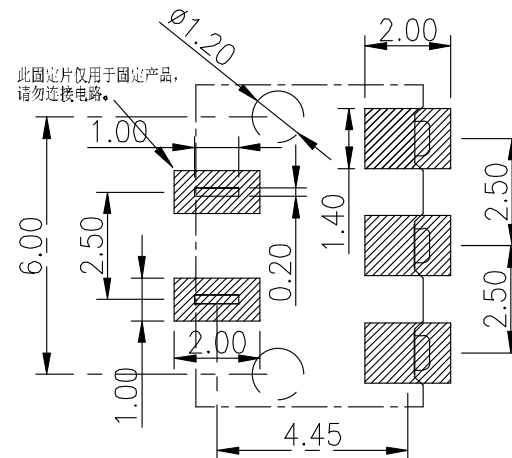
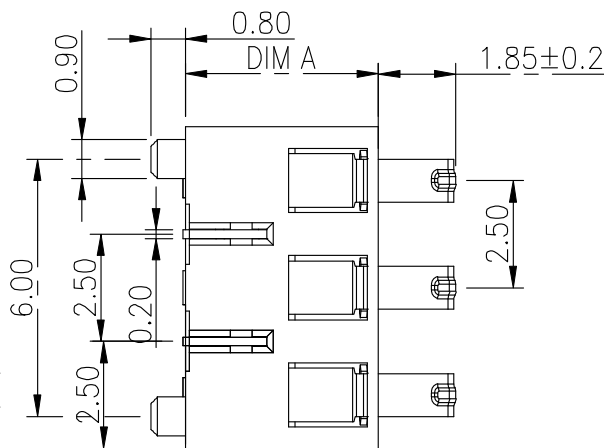
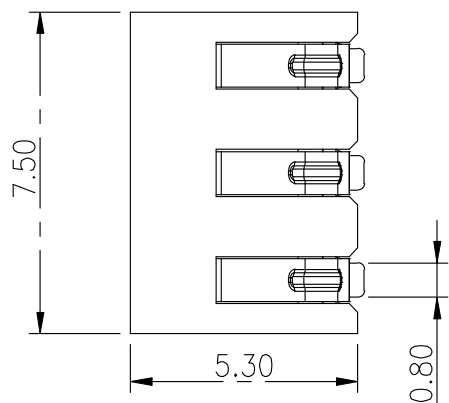

RECOMMENDED PCB LAYOUT
TOP VIEW (. XX±0.05)

| PART NO. | DIM A | DIM B | | | | | | |
|-----------|-------|----------|-----|------------------|-----------------|------|-----------|--|
| BC-1-318 | 4.0 | 5.90±0.2 | 2 | HOUSING | LCP | 1 | BLACK | |
| BC-1-318A | 4.5 | 6.40±0.2 | 1 | CONTACT TERMINAL | PHOSPHOR BRONZE | 3 | Au PLATED | |
| BC-1-318B | 5.5 | 7.40±0.2 | NO. | PARTS | MATERIAL | QTY. | FINISHING | |

东莞市朗顿电子科技有限公司

COPYRIGHT RESERVED, PLEASE DO NOT COPY.

| PART NAME | | CONNECTOR | | DRAWING | | G.B.Wu | | DWG.No. | | DS-BC-102 | |
|-----------|--|--|--|----------|--|---------|--|---------|--|------------|--|
| PART NO. | | BC-1-318 318A 318B | | CHECK | | Q.L.Dai | | REV. | | A0 | |
| UNIT : mm | | TOLERANCE : UP TO 5 ±0.2 ABOVE 5 30 ~ ±0.3 ABOVE 30 ±0.5 OTHERWISE ±3' | | APPROVAL | | SCALE | | DATE | | 30-08-2017 | |
| | | | | SCALE | | 2:1 | | PAGE | | 1 OF 1 | |